

**RESIDENTIAL**

City of Chilton, 42 School Street, Chilton, WI 53014 Phone: (920)849-2451 Fax: (920) 849-2025

Permit Application No.  Today's Date:

Tax Parcel I.D. No. (30 digits)  or Location I.D. # (5 digits)

Owner of Property

Mailing Address

Phone No.

Project Location (Building Address)

Square Feet of Project

Estimated Cost of Project

Describe Project Type \_\_\_\_\_

**Building Permit**

Contractor's Name  License/Certification No.

Mailing Address

Phone No.

**Plumbing Permit**

Contractor's Name  License/Certification No.

Mailing Address

Phone No.

**Water Softener YES or NO**

**Electrical Permit**

Contractor's Name  License/Certification No.

Mailing Address

Phone No.

**HVAC Permit**

Contractor's Name  License/Certification No.

Mailing Address

Phone No.

**Sign Permit**

Contractor's Name  License/Certification No.

Mailing Address

Phone No.

# Cautionary Statement To Owners Obtaining Building Permits

101.65(lr) of the Wisconsin Statutes requires municipalities that enforce the Uniform Dwelling Code to provide an owner who applies for a building permit with a statement advising the owner that if the owner hires a contractor to perform work under the building permit and the contractor is not bonded or insured as required under s.101.654(2)(a), the following consequences might occur:

- a. The owner may be held liable for any bodily injury to or death of others or for any damage to the property of others that arises out of the work performed under the building permit or that is caused by any negligence by the contractor that occurs in connection with the work performed under the building permit.
- b. The owner may not be able to collect from the contractor damages for any loss sustained by the owner because of a violation by the contractor of the one and two family dwelling code or an ordinance enacted under sub.(1)(a), because of any bodily injury to or death of others or damage to the property of others that arises out of the work performed under the building permit or because of any bodily injury to or death of others or damage to the property of others that is caused by any negligence by the contractor that occurs in connection with the work performed under the building permit.

You are hereby advised that the owner, as defined in 101.01(2)(e) of Wisconsin State Statutes is responsible for all code requirements not specifically cited herein.

The Applicant (Property Owner or Contractor) agrees to comply with the Wisconsin Uniform Dwelling Code, Wisconsin Enrolled Commercial Building Code, and all other applicable codes and municipal ordinances and with the conditions of this permit. The Applicant understands that the issuance of the permit creates no legal liability, express or implied, on the Inspection Agency or municipality and certifies that the information is accurate. The Applicant agrees to allow the building inspection and assessing to access the property for the inspection of this permit. Applicant is responsible for calling and scheduling all inspections to close out the permit once work is complete.

Applicant signature agrees to the terms of this Permit Application.

Signature of Property Owner \_\_\_\_\_ Date

or

Signature of Contractor \_\_\_\_\_ Date

Conditionally Approved By City Administrator \_\_\_\_\_ Date

Conditions of Approval:

---

---

---

---

*It is the Applicant's responsibility to know where lot lines are.*

Permit Denied By City Administrator \_\_\_\_\_ Date

Reason for Denial: \_\_\_\_\_

---

---

---

**Fee Schedule**

Additions - All Inclusive	\$250.00	
Remodel - All Inclusive	\$250.00	
Attached Garage/Shed (Includes Electric)	\$250.00	
Unattached Garage/Shed (No Electric)	\$50.00	
Unattached Garage/Shed (Includes Electric)	\$150.00	
Electric Service	\$100.00	
Electrical	\$100.00	
Plumbing	\$100.00	
Heating and/or Air Conditioning	\$60.00	
Doors/Siding/Windows/Roof*	\$50.00	
Deck - All Inclusive	\$200.00	
Boat House (Includes Electric)	\$200.00	
Foundation Repair	\$60.00	
Fence	\$60.00	
Annual Pool Permit	\$50.00	
Pool Permit (Includes Plumbing/Electrical)	\$200.00	
Miscellaneous/Single Inspection	\$50.00	
Administrative Review***	\$50.00	
Escrow (Refundable after Final Inspection)	\$50.00	

\*Code specifies the maximum number of roof layers is two.

**TOTAL**

**Inspections Required**

<input type="checkbox"/>	Footing
<input type="checkbox"/>	Foundation
<input type="checkbox"/>	Plumbing
<input type="checkbox"/>	Electric
<input type="checkbox"/>	Electric Service
<input type="checkbox"/>	Erosion Control
<input type="checkbox"/>	Rough-In**
<input type="checkbox"/>	Insulation
<input type="checkbox"/>	Final

\*\*Rough In includes Construction Wire, Plumbing, HVAC

\*\*\*Includes Additions, Unattached Garage/Shed, Decks, Boat Houses, Pools, Fence

**PLOT MAP**

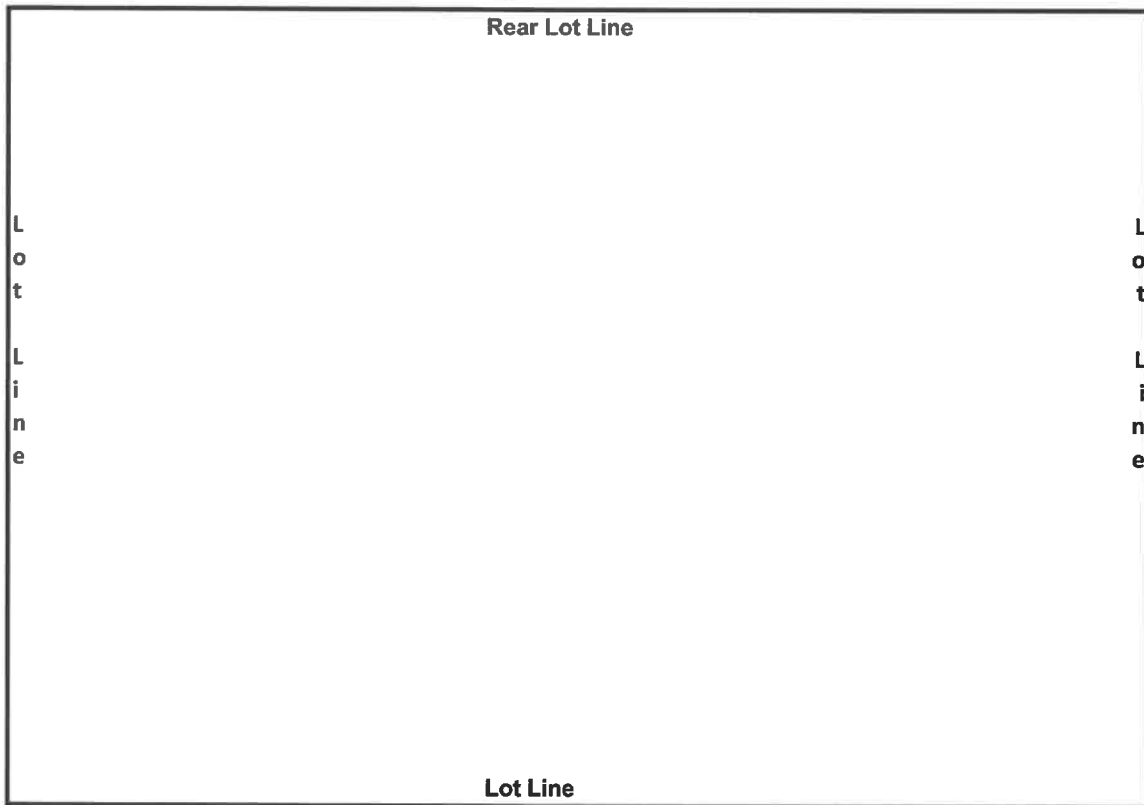

Right-Of Way

Street Name

Amount Paid  Receipt No.  By

**Brian Witkowski, Building Inspector, License #1469271, Cell (920)912-0832 - witkoinspections@gmail.com**

Application fees are nonrefundable. Please be advised that this application is public information.